



State of Alaska
Department of Fish and Game
Sportfish Division

Nomination Form
Anadromous Waters Catalog

Region Southeastern

USGS Quad(s) JUNEAU A-4

Anadromous Waters Catalog Number of Water Body 114-27-10300-2018-3000

Name of Water Body ☐ USGS Name ☐ Local Name

☒ Addition ☐ Deletion ☐ Correction ☐ Backup Information

For Office Use

Nomination #	<u>24-625</u>	<u>Adam Rimmer</u>	<u>7-8-2024</u>
		Fisheries Scientist	Date
Revision Year:	<u>2025</u>	<u>Ron Bankers</u>	<u>7/9/2024</u>
		Habitat Operations Manager	Date
Revision to:	<input checked="" type="checkbox"/> Atlas	<u>Joseph Rimmer</u>	<u>28 June 2024</u>
	<input checked="" type="checkbox"/> Catalog	AWC Project Biologist	Date
Revision Code:	<u>A-2 E-9</u>	<u>P. L.</u>	<u>7/18/2024</u>
		GIS Analyst	Date

OBSERVATION INFORMATION

Species	Date(s) Observed	Spawning	Rearing	Present	Anadromous
coho salmon	10/01/2023		✓		✓
Dolly Varden	10/01/2023		✓	✓	
cutthroat trout	10/01/2023		✓	✓	

~ADD new AWC Stream #114-27-10300-2018-3000 with COHO salmon REARING.

~ADD new BARRIER above new AWC Stream #114-27-10300-2018-3000.

Process Nom #24-624 first.

Comments:

Add this uncataloged stream to the anadromous waters catalog for rearing coho salmon and add anadromous fish barrier.
Coordinates (Lat,Long): Upper(58.032367,-135.281692) Lower(58.031580,-135.276145)

Name of Observer (please print): Flynn Casey

Signature: 10.231.39.10 (Web Nomination) Date: 02/20/2024

Agency: _____

Address: PO Box 110024

Juneau, AK 99811

This certifies that in my best professional judgment and belief the above information is evidence that this waterbody should be included in or deleted from the Anadromous Waters Catalog.

Signature of Area Biologist: _____ Date: _____ Revision 3/16

Name of Area Biologist (please print): _____

Alaska Department of Fish and Game

Habitat Section
Southeast Region



114-27-10300-2018 Tributary 1

ADDITION

Water body name:

Quad: Juneau A-4

Upper Reach Latitude: 58.032367 **Longitude:** -135.281692

Lower Reach Latitude: 58.031580 **Longitude:** -135.276145

Survey date: 10/1/2023

Species & Lifestage:

Survey crew: FC, CD

Findings: We surveyed this uncataloged stream up to an anadromous fish barrier using a backpack electrofisher and GPS. We captured juvenile coho salmon, Dolly Varden, and cutthroat trout. The tributary stream descends a series of bedrock falls in quick succession, accumulating enough gradient to meet the specifications of a FRPA barrier to anadromous fish passage; it has quality rearing and spawning habitat downstream of the barrier (Table 1; Figures 1–4).

Recommendations: Add this uncataloged stream to the anadromous waters catalog for rearing coho salmon and add anadromous fish barrier (Figure 5).

Nomination: Pending

Table 1.–114-27-10300-2018 tributary 1 survey data.

Waypoint	Latitude	Longitude	Notes	Stream Width ft	Stream Substrate	Habitat Features	Gradient %	Sample Effort	Sample Results
988	58.031573	-135.280048	1-yr and 2-yr CO capture.	15-20	Small Gravel Large Gravel	Spawning Substrate	4-6	EF	3 CO
989	58.031563	-135.280511	Resident fish capture ~40' downstream of newer bridge installation. 2-3' tall log jam falls ~20' further downstream.	15-20	Large Gravel Small Gravel	Spawning Substrate	4-6	EF	1 CT
990	58.032024	-135.281165	2+-year CO capture in pool just downstream of log jam/ rootwad cascade. Gradient increasing compared to downstream.	15-20	Large Gravel Small Gravel	Spawning Substrate	6-8	EF	3 CO 2 DV 2 CT
991	58.032166	-135.281240	1-yr CO capture upstream of log jam/rootwad cascade.	12-15	Large Gravel Small Gravel		2-4	EF	2 CO 2 CT 1 DV
992	58.032344	-135.281438	Juvenile CO capture just downstream of series of waterfalls in quick succession, accumulating a >24% gradient over 25' or less and constituting a FRPA barrier.	10-12	Cobble Large Gravel	Spawning Substrate Incised Channel		EF	3 CO



Figure 1.—Juvenile coho salmon captured at waypoint 992.



Figure 2.—Bridge at waypoint 989.



Figure 3.—Upstream view of channel at waypoint 990.



Figure 4.—Series of bedrock falls just upstream of waypoint 992.

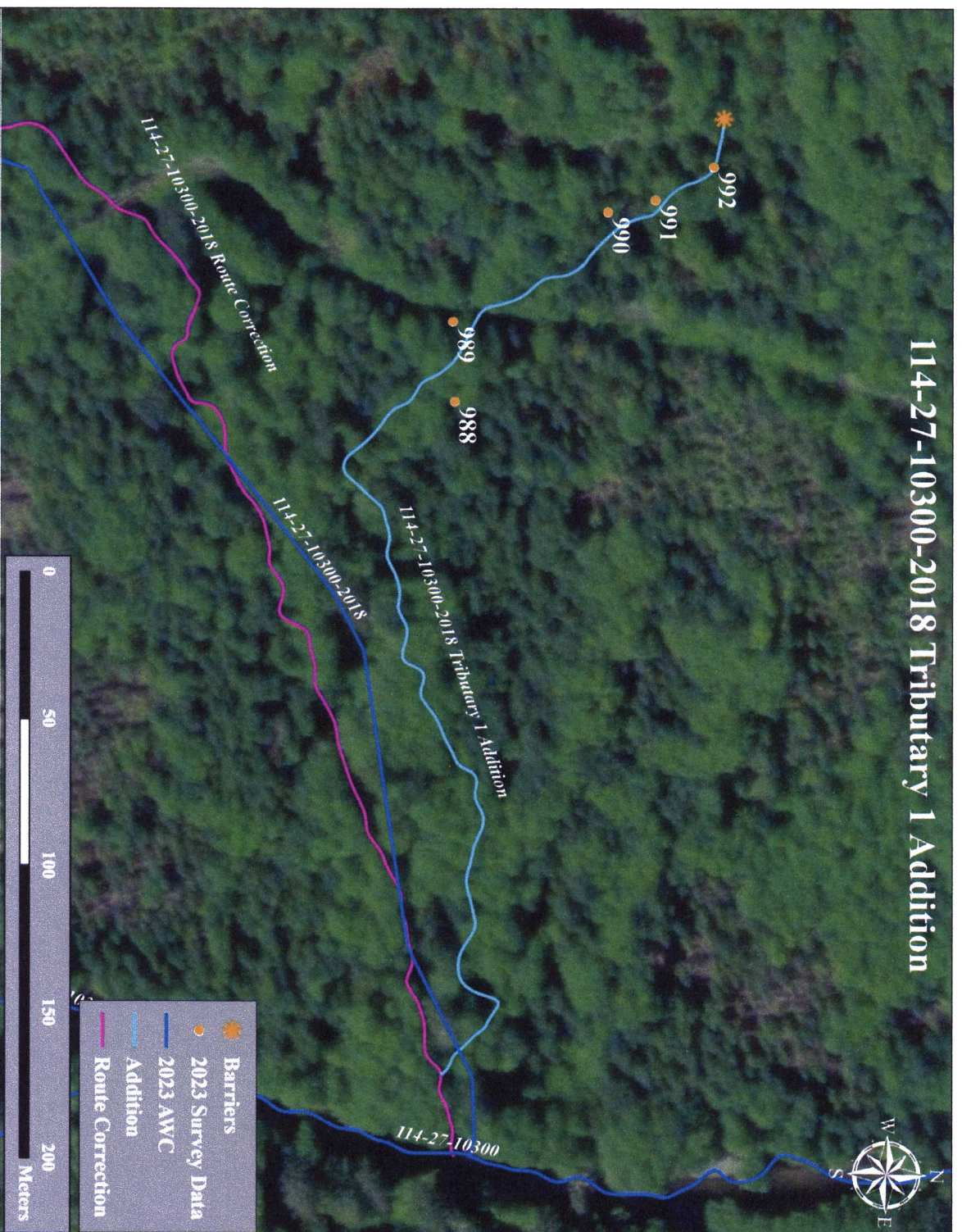
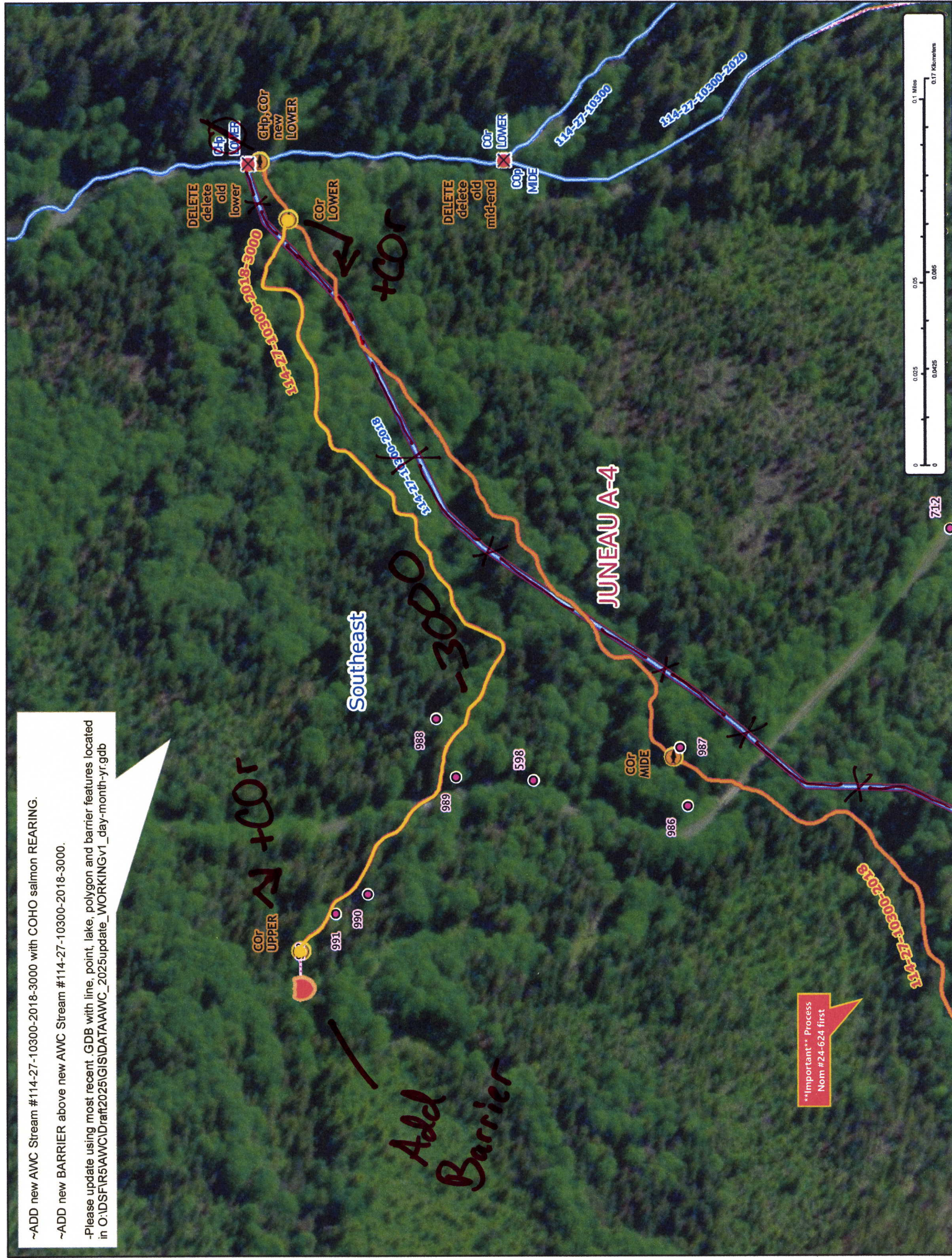

Figure 5.—114-27-10300-2018 tributary 1 addition map.

~ADD new AWC Stream #114-27-10300-2018-3000 with COHO salmon REARING.

~ADD new BARRIER above new AWC Stream #114-27-10300-2018-3000.

-Please update using most recent .GDB with line, point, lake, polygon and barrier features located in O:\D\SPR\5\AWC\Draft\2025\GIS\DATA\AWC_2025update_WORKINGv1_day-month-yr.gdb



Map #2

Nom #24-625