



State of Alaska
Department of Fish and Game
Sportfish Division

Nomination Form
Anadromous Waters Catalog

Region Southeastern

USGS Quad(s) SITKA D-5

Anadromous Waters Catalog Number of Water Body 114-31-10130-2071

Name of Water Body ☐ USGS Name ☐ Local Name

☒ Addition ☐ Deletion ☐ Correction ☐ Backup Information

For Office Use

Nomination # <u>24-600</u>	<u>Adam Reim</u> Fisheries Scientist Date <u>7-10-2024</u>
Revision Year: <u>2025</u>	<u>Ron Bankert</u> Habitat Operations Manager Date <u>7/18/2024</u>
Revision to: <input checked="" type="checkbox"/> Atlas <input checked="" type="checkbox"/> Catalog	<u>Paul Shaffer</u> AWC Project Biologist Date <u>27-June 2024</u>
Revision Code: <u>A-2d</u>	<u>P. en</u> GIS Analyst Date <u>7/22/2024</u>

OBSERVATION INFORMATION

Species	Date(s) Observed	Spawning	Rearing	Present	Anadromous
coho salmon	07/20/2022		✓		✓
Dolly Varden	07/20/2022		✓	✓	
cutthroat trout	07/20/2022		✓	✓	

~ADD new AWC Stream #114-31-10130-2071 with COHO salmon REARING.

Comments:

Add this uncataloged stream to the anadromous waters catalog for rearing coho salmon.
Coordinates (Lat,Long): Upper(57.962794,-135.429144) Lower(57.962659,-135.42968)

Name of Observer (please print): Flynn Casey
Signature: 10.231.39.10 (Web Nomination) Date: 02/20/2024
Agency: _____
Address: PO Box 110024
Juneau, AK 99811

This certifies that in my best professional judgment and belief the above information is evidence that this waterbody should be included in or deleted from the Anadromous Waters Catalog.

Signature of Area Biologist: _____ Date: _____ Revision 3/16
Name of Area Biologist (please print): _____

Alaska Department of Fish and Game

Habitat Section
Southeast Region



114-31-10130 Tributary 15

ADDITION

Water body name:

Quad: Sitka D-5

Upper Reach Latitude: 57.962794 **Longitude:** -135.429144

Lower Reach Latitude: 57.962659 **Longitude:** -135.429680

Survey date: 7/20/2022

Species & Lifestage:

Survey crew: FC, RR

Findings: We surveyed this uncataloged stream using a backpack electrofisher and GPS. We captured juvenile coho salmon, Dolly Varden, and cutthroat trout. The tributary stream descends into a low-gradient channel at the base of a hillside with quality coho salmon rearing habitat (Table 1; Figures 1, 2).

Recommendations: Add this uncataloged stream to the anadromous waters catalog for rearing coho salmon (Figure 3).

Nomination: Pending

Table 1.—114-31-10130 tributary 15 survey data.

Waypoint	Latitude	Longitude	Notes	Stream Width ft	Stream Substrate	Habitat Features	Gradient %	Sample Effort	Sample Results
1175	57.962771	-135.429139	Start of survey on tributary.	6-8	Small Gravel Fine Organic	SWD Spawning Substrate	2-4	EF	3 DV 2 CT 2 CO
1176	57.963079	-135.428674	Tributaries split, river-left has a 1' tall falls onto clay with no jump pool. River-right is the main and is a small stream with good rearing habitat. Dropdowns are for river-right.	1-2	Small Gravel	Incised Channel	1-2	EF	1 CT
1177	57.963118	-135.428049		2-4	Fine Organic Sand	Incised Channel	1-2	EF	No Fish



Figure 1.—Juvenile coho salmon captured at waypoint 1175.



Figure 2.—Channel at waypoint 1175.

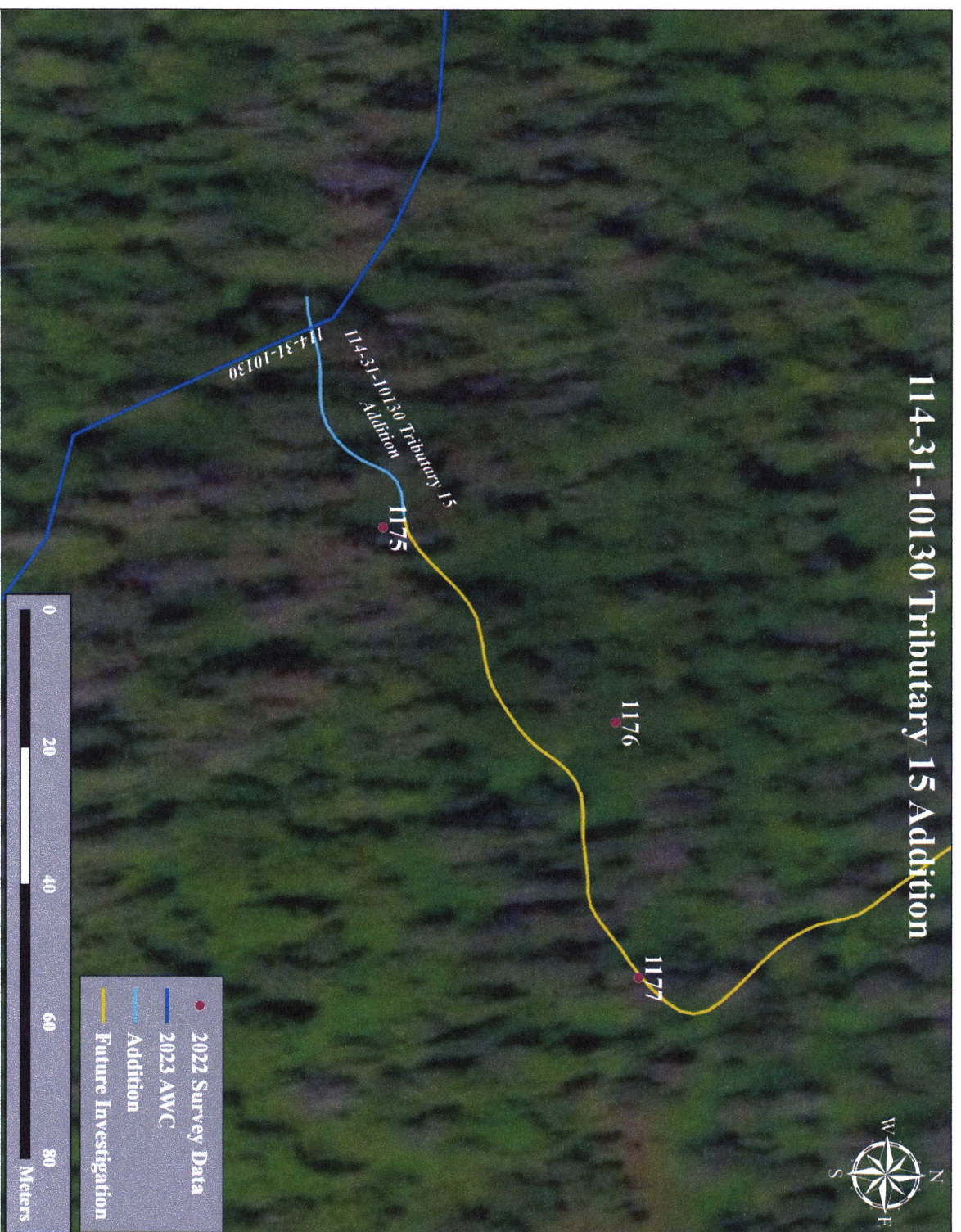

Figure 3.-114-31-10130 tributary 15 addition map.

JUNEAU A-5 SE
A-5



SITKA D-5

Southeast

*See Also Nom's #24-590, #24-591, #24-592, #24-593, #24-595, #24-596, #24-597, #24-598, #24-599, #24-608, #24-609, #24-611, #24-612

~ADD new AWC Stream #114-31-10130-2071 with COHO salmon REARING.

-Please update using most recent .GDB with line, point, lake, polygon and barrier features located in O:\DS\FIR5\AWC\Draft2025\GIS\DATA\AWC_2025update_WORKINGv1_day-month-yr.gdb

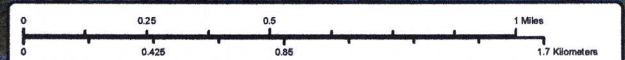

Nom #24-600

Map #1

~ADD new AWC Stream #114-31-10130-2071 with COHO salmon REARING.
-Please update using most recent .GDB with line, point, lake, polygon and barrier features located in O:\DSF\IR5\AWC\Draft2025\GIS\DATA\AWC_2025update_WORKINGv1_day-month-yr.gdb

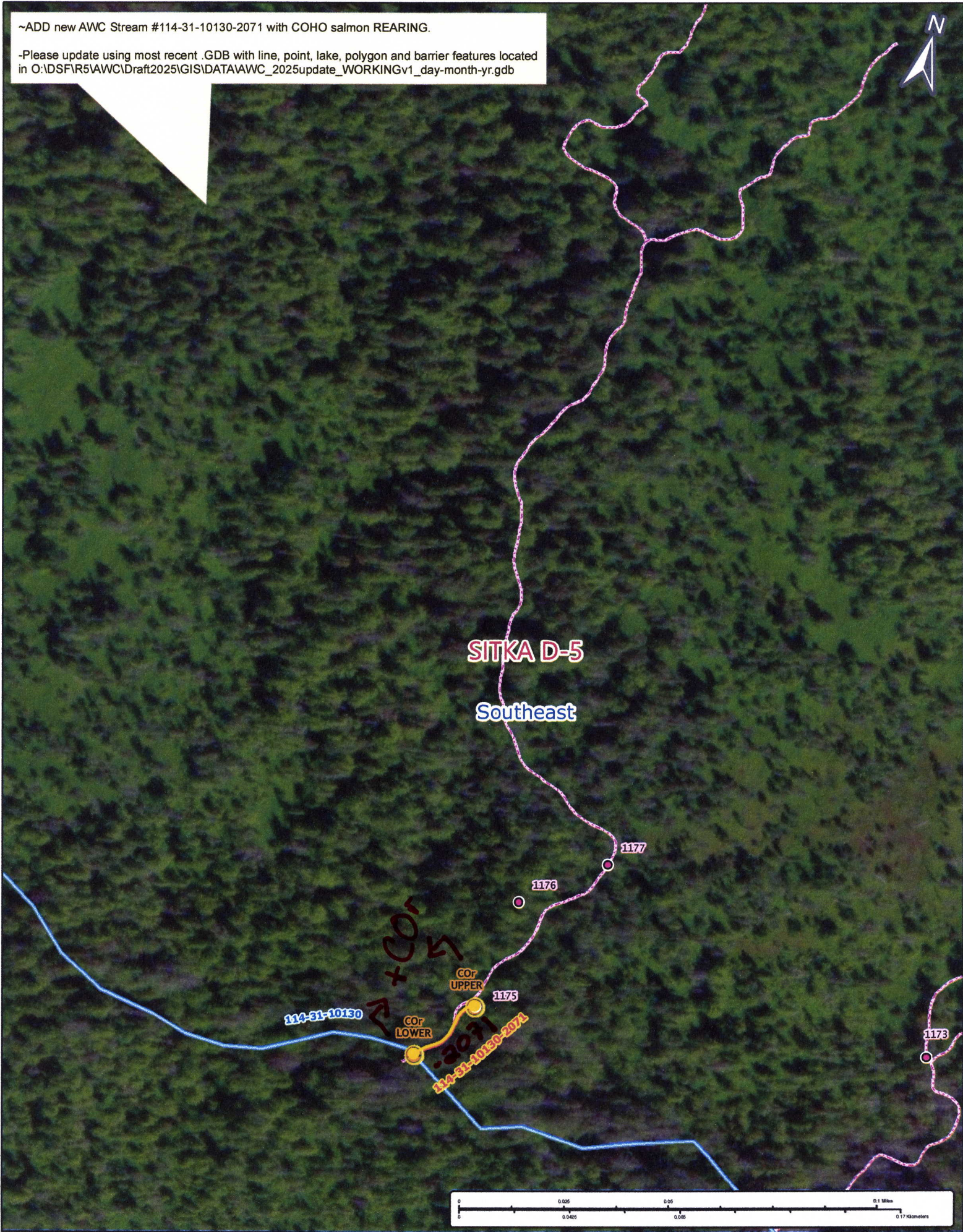

Num #24-600

Map #2