



State of Alaska  
Department of Fish and Game  
Sportfish Division

Nomination Form  
Anadromous Waters Catalog

Region Southeastern

USGS Quad(s) JUNEAU A-5 SE

Anadromous Waters Catalog Number of Water Body 114-31-10130-2004

Name of Water Body  ☐ USGS Name ☐ Local Name

☒ Addition ☐ Deletion ☒ Correction ☐ Backup Information

For Office Use

Nomination # <u>24-564</u>	<u>Adam Reimer</u> Fisheries Scientist Date <u>7-10-2024</u>
Revision Year: <u>2025</u>	<u>Ken Benkert</u> Habitat Operations Manager Date <u>7/10/2024</u>
Revision to: <input checked="" type="checkbox"/> Atlas <input checked="" type="checkbox"/> Catalog	<u>Chris Lips</u> AWC Project Biologist Date <u>26 June 2024</u>
Revision Code: <u>C-9, A-1, B-1</u>	<u>N. H. H.</u> GIS Analyst Date <u>7/22/24</u>

OBSERVATION INFORMATION

Species	Date(s) Observed	Spawning	Rearing	Present	Anadromous
pink salmon	09/01/2021	✓			✓
coho salmon	09/01/2021		✓		✓
Dolly Varden	09/01/2021		✓	✓	
cutthroat trout	06/27/2022		✓	✓	

~UPDATE/ADJUST hydrography of existing AWC Stream #114-31-10130-2004.

~EXTEND existing AWC Stream #114-31-10130-2004 with COHO salmon REARING.

~ADD new species PINK salmon SPAWNING to existing AWC Stream #114-31-10130-2004.

Comments:

Extend upper extent of Stream No. 114-31-10130-2004 in the anadromous waters catalog. Add spawning pink salmon to species list. Use LiDAR predictions of stream hydrography to correct the route of the currently cataloged portion of stream.  
Coordinates (Lat,Long): Upper(58.059066,-135.491553) Lower(58.062201,-135.48748)

Name of Observer (please print): Flynn Casey  
Signature: 10.231.39.10 (Web Nomination) Date: 02/20/2024  
Agency: \_\_\_\_\_  
Address: PO Box 110024  
Juneau, AK 99811

This certifies that in my best professional judgment and belief the above information is evidence that this waterbody should be included in or deleted from the Anadromous Waters Catalog.

Signature of Area Biologist: \_\_\_\_\_ Date: \_\_\_\_\_ Revision 3/16  
Name of Area Biologist (please print): \_\_\_\_\_

# Alaska Department of Fish and Game

Habitat Section  
Southeast Region



**114-31-10130-2004**

## ADDITION & ROUTE CORRECTION

**Water body name:**

**Survey date:** 9/1/2021; 6/27/2022; 7/5/2022

**Quad:** Juneau A-5

**Species & Lifestage:** CO<sub>r</sub>

**Upper Reach Latitude:** 58.059066 **Longitude:** -135.491553

**Survey crew:** DK, FC, RR

**Lower Reach Latitude:** 58.062201 **Longitude:** -135.487480

**Findings:** We surveyed this cataloged stream using a backpack electrofisher, baited minnow traps, and GPS. We captured juvenile coho salmon, Dolly Varden, cutthroat trout, and sculpin. We also observed spawning pink salmon. The tributary stream falls over at least two large (about 4 ft tall) log jams, one of which seems to comprise a temporary barrier to fish passage as it is collecting gravel and burying the stream channel (Table 1; Figures 1–4).

**Recommendations:** Extend upper extent of Stream No. 114-31-10130-2004 in the anadromous waters catalog. Add spawning pink salmon to species list. Use LiDAR predictions of stream hydrography to correct the route of the currently cataloged portion of stream (Figure 5).

**Nomination:** Pending

Table 1.—114-31-10130-2004 survey data.

Waypoint	Latitude	Longitude	Notes	Stream Width ft	Stream Substrate	Habitat Features	Gradient %	Sample Effort	Sample Results
2279	58.061618	-135.488352	Adult pinks spawning. No armor on river-right, starting to undercut on downstream end.	15-20	Small Gravel Large Gravel	Spawning Substrate	2-4	MT	12 P 3 CO 1 DV
865	58.056326	-135.496384	Stream flowing under bridge. Bridge looks to be in good condition.	6-8	Small Gravel Large Gravel		4-6	MT	1 DV 2 CT
921	58.056528	-135.496136	Small waterfall caused by log jam, ~1' tall.	15-20	Cobble		4-6	EF	4 CT
922	58.057155	-135.495046	Grade decreased slightly compared to upstream.	15-20	Large Gravel Cobble		2-4	EF	7 CT 2 DV
923	58.057486	-135.494835	Large log jam, ~4' tall with no real jump pools. Water seeps between the logs.						2 CT
924	58.058076	-135.493823	Log jam section.				6-8	EF	2 CT
925	58.058208	-135.493123	Grade lowers compared to upstream and stream is not incised downstream. Upstream the stream is incised ~50' in a canyon.						
926	58.059075	-135.491574	Grade flattens out compared to upstream. Young-of-year CO. Log jam upstream blocks fish passage.	15-20	Large Gravel Cobble		1-2	EF	4 CO
927	58.058891	-135.491973	Log jam ~4' tall. Water seeps through gravel, blocking fish passage. Resident fish capture only upstream.	15-20	Large Gravel		2-4	EF	4 CT 1 SC





Figure 1.—Pink salmon spawning in channel at waypoint 2279.



Figure 2.—Eroding river-right bridge abutment at waypoint 2279.



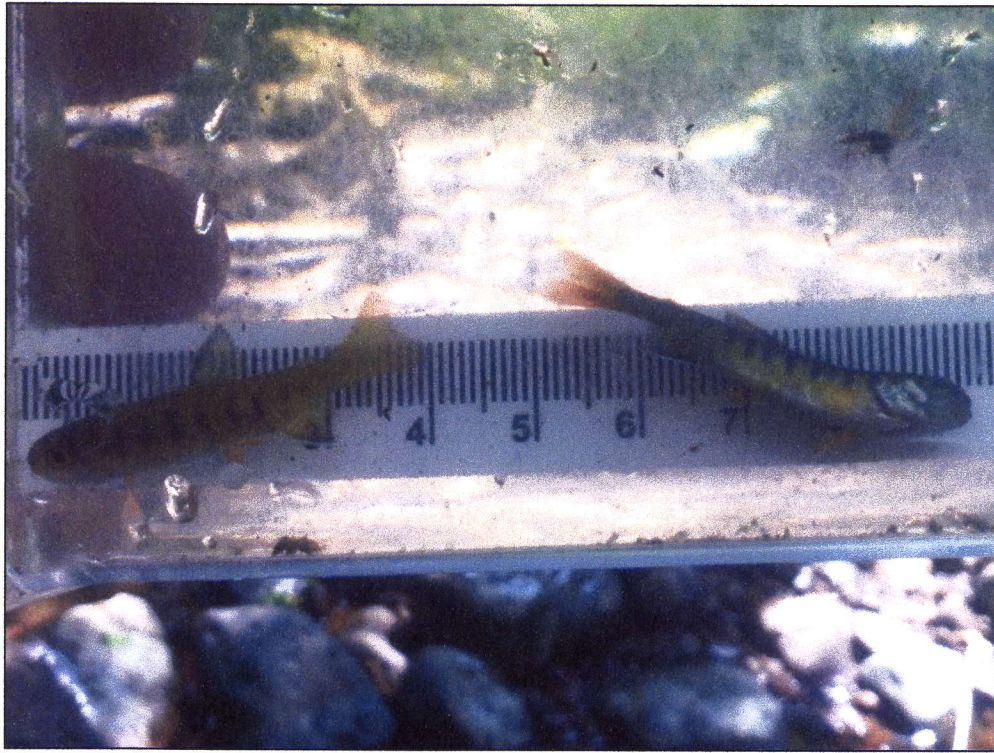

Figure 3.—Juvenile coho salmon captured at waypoint 926.



Figure 4.—Temporary fish block comprised of a large log jam collecting gravel sediment at waypoint 927.



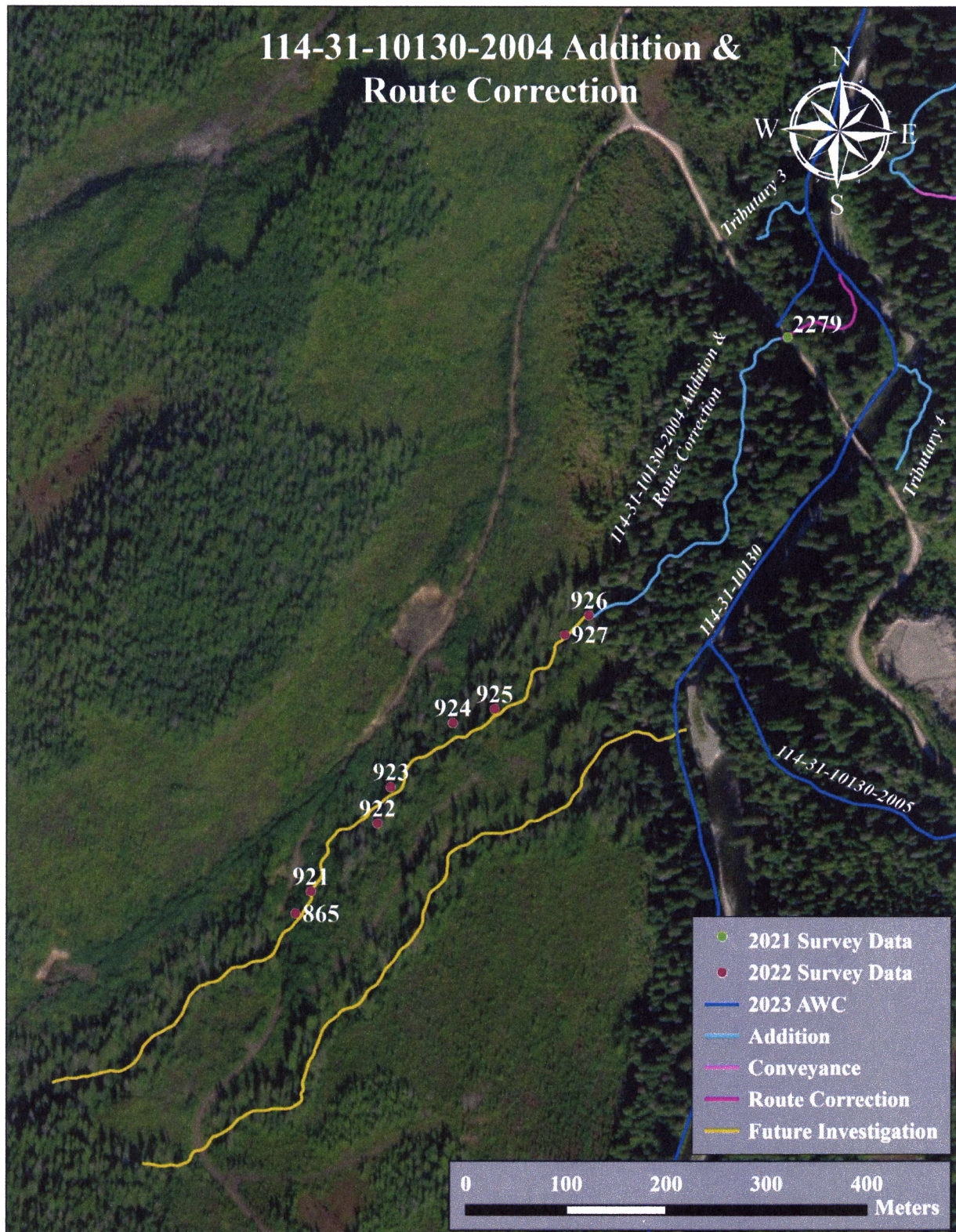
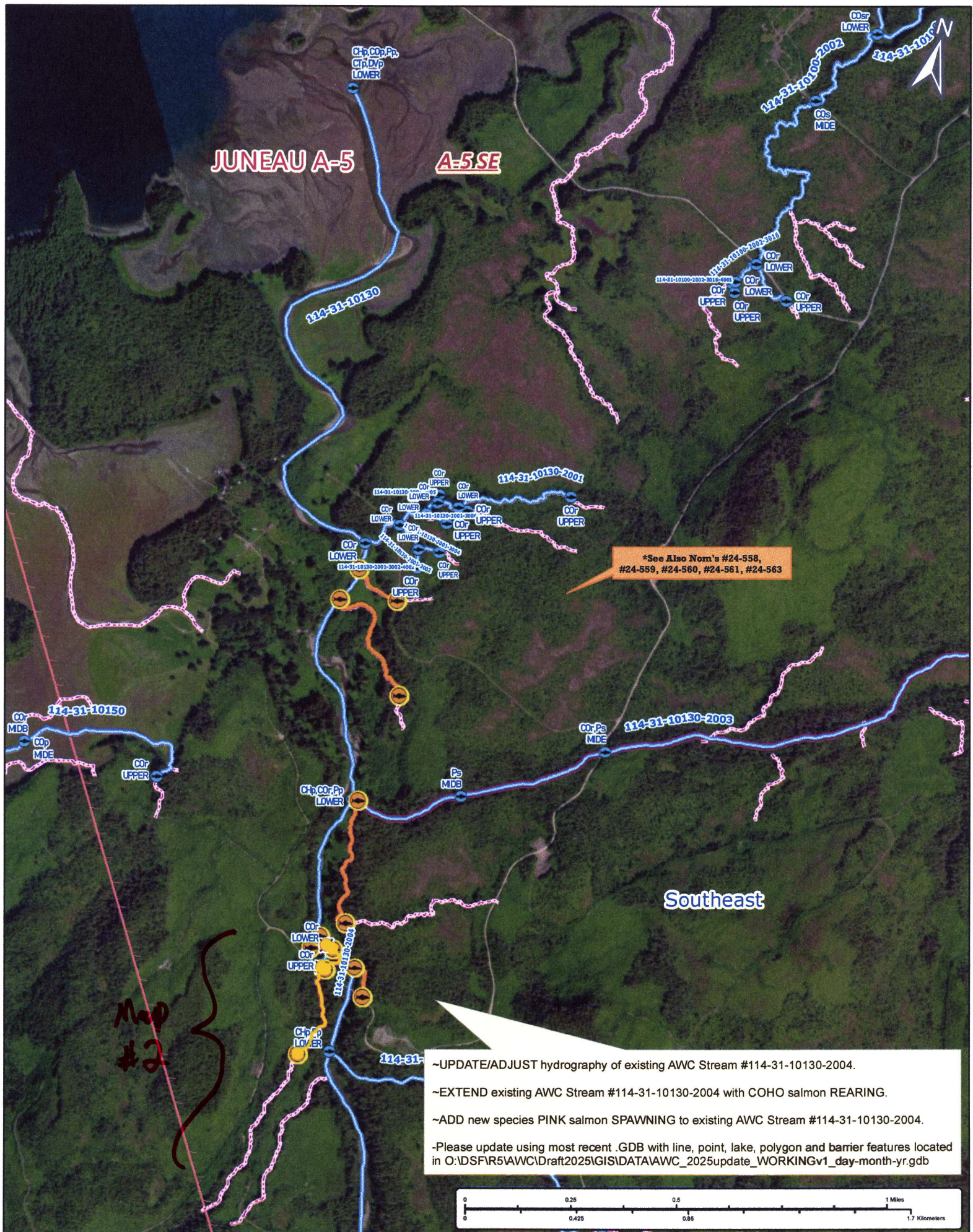

Figure 5.—Stream No. 114-31-10130-2004 addition & route correction map.





\*See Also Nom's #24-558,  
#24-559, #24-560, #24-561, #24-563

- ~UPDATE/ADJUST hydrography of existing AWC Stream #114-31-10130-2004.
- ~EXTEND existing AWC Stream #114-31-10130-2004 with COHO salmon REARING.
- ~ADD new species PINK salmon SPAWNING to existing AWC Stream #114-31-10130-2004.
- ~Please update using most recent .GDB with line, point, lake, polygon and barrier features located in O:\DSF\R5\AWC\Draft2025\GIS\DATA\AWC\_2025update\_WORKINGv1\_day-month-yr.gdb

Nom #24-564

Map #1



